

Architectural Inventory Form

Official Eligibility Determination (for OAHP use only)

- Date _____ Initials _____
- Determined Eligible - National Register
 - Determined Not Eligible - National Register
 - Determined Eligible - State Register
 - Determined Not Eligible - State Register
 - Need Data
 - Contributes to eligible National Register District
 - Noncontributing to eligible NR District

I. Identification

1. Resource number: 5HN68.91
2. Temporary resource number: 46
3. County: Hinsdale
4. City: Lake City
5. Historic building name: *Carl Residence*
6. Current building name: *Hensley Residence*
7. Building address: 101B Silver Street, Lake City, CO 81235
8. Owner name and address: Betty Hensley c/o C. R. Hensley, P.O. Box 3040 , Lubbock TX 79542

II. Geographic Information

County Property No.: R1045

9. P.M. *6th NM* Township 44N Range 4W NE4 of NW4 of NW4 of Section 34
10. UTM reference
Zone 13 *296530*⁴³ mE *4211140*³⁴ mN
11. USGS quad name: Lake City Quad year: 1985 Map scale: X 7.5' ___ 15'
12. Block(s): 72 Lot(s): 13-16 Legal: W 1/2 of 13-16, Block 72
Addition: _____ Year of Addition: _____
13. Boundary description and justification: Perimeter of parcel

III. Architectural Description

14. Building plan: Rectangular
15. Dimensions: 1485 square feet
16. Number of stories: 1
17. External wall material(s): Horizontal siding - *Aluminum per # 29*
18. Roof configuration: Front gabled
19. Roof material: Composition
20. Special features: Chimney
21. General architectural description:
One-story, front-gabled dwelling. Composition roofing. Originally a trailer/mobile home, now covered in wide horizontal siding. Shed-roofed front porch enclosed in siding and vertical fixed sash windows. Small shed-roofed vestibule at northwest corner. Concrete block chimney on east elevation. Concrete foundation.
22. Architectural style/Building type: No style
23. Landscaping or special setting:

24. Associated building, features or objects:
Shed, circa 1960
One-story, shed-roofed building of concrete block. Four-lite window in west elevation; solid door in south elevation.

IV. Architectural History

25. Date of construction Estimate: 1960 Actual: _____ Source of info: NEWS-CHAMPION, Thurs., May 18, 1961, page 2
26. Architect: None Source of info:
27. Builder/contractor: Unknown Source of info: NEWS-CHAMPION, Thurs., May 18, 1961, page 2
28. Original owner: Vernon "Tub" and Theresa Carl Source of info: NEWS-CHAMPION, May 18, 1961
29. Construction history (major additions, alterations, demolitions):
Trailer/mobile home covered in wide aluminum siding and expanded with enclosed front porch circa 1961.
30. Original location: Moved Date of move(s) _____

V. Historical Associations

31. Original use(s): Single dwelling
32. Intermediate use(s):
33. Current use(s): Single dwelling
34. Site type(s):
35. Historical background:
Vernon Carl and his wife, Teresa, lived in a mobile home at this location from c. 1961 until moving to the Hughes-Bell Cabin, 304 Third. The Carl mobile home was later sold to Homer and Betty Hensley. The trailer was sided over and, with a large addition to the east, forms the nucleus of the present house
36. Sources of information:
Gunnison NEWS-CHAMPION, Thurs., May 18, 1961, page 2.

VI. Significance

37. Local landmark: Yes No Date of design.: _____ Design. authority: _____
Within Lake City Historic District (local historic district)
38. Applicable National Register Criteria:
- A. Associated with events that have made a significant contribution to the broad pattern of our history;
 - B. Associated with the lives of persons significant in our past;
 - C. Embodies the distinctive characteristics of a type, period, or method of construction, or represents the work of a master, or that possesses high artistic values, or represents a significant and distinguishable entity whose components may lack individual distinction; or
 - D. Has yielded, or may be likely to yield, information important in history or prehistory
 - Qualifies under Criteria Considerations A through G
 - Does not meet any of the above National Register criteria
39. Area(s) of significance:
40. Period of significance:
41. Level of significance: National State Local
42. Statement of significance:
This recently constructed house does not contribute to the Lake City Historic District.
43. Assessment of historic physical integrity to significance:

VII. National Register Eligibility Assessment

44. National Register eligibility field assessment: Eligible Not Eligible Need Data
45. Is there National Register district potential? Yes No
Discuss _____
If there is National Register district potential, is this building Contributing Noncontributing
46. If the building is in an existing National Register district is it? Contributing Noncontributing
(Lake City National Historic District)

VIII. Recording Information

47. Photograph numbers: Roll 13, frames 21, 22 Negatives filed at: Lake City Town Hall
48. Report title: 2003 Architectural Survey of Lake City, Colorado
49. Date(s): September 2002 - June 2003
50. Recorders Cathleen M. Norman and Grant E. Houston
51. Organization: Town of Lake City
52. Address: 230 Bluff Street, Lake City CO 81235 53. Phone no. (970) 944-2333

Colorado Historical Society - Office of Archaeology and Historic Preservation
1300 Broadway, Denver CO 80203 (303) 866-3395

NOT TO SCALE

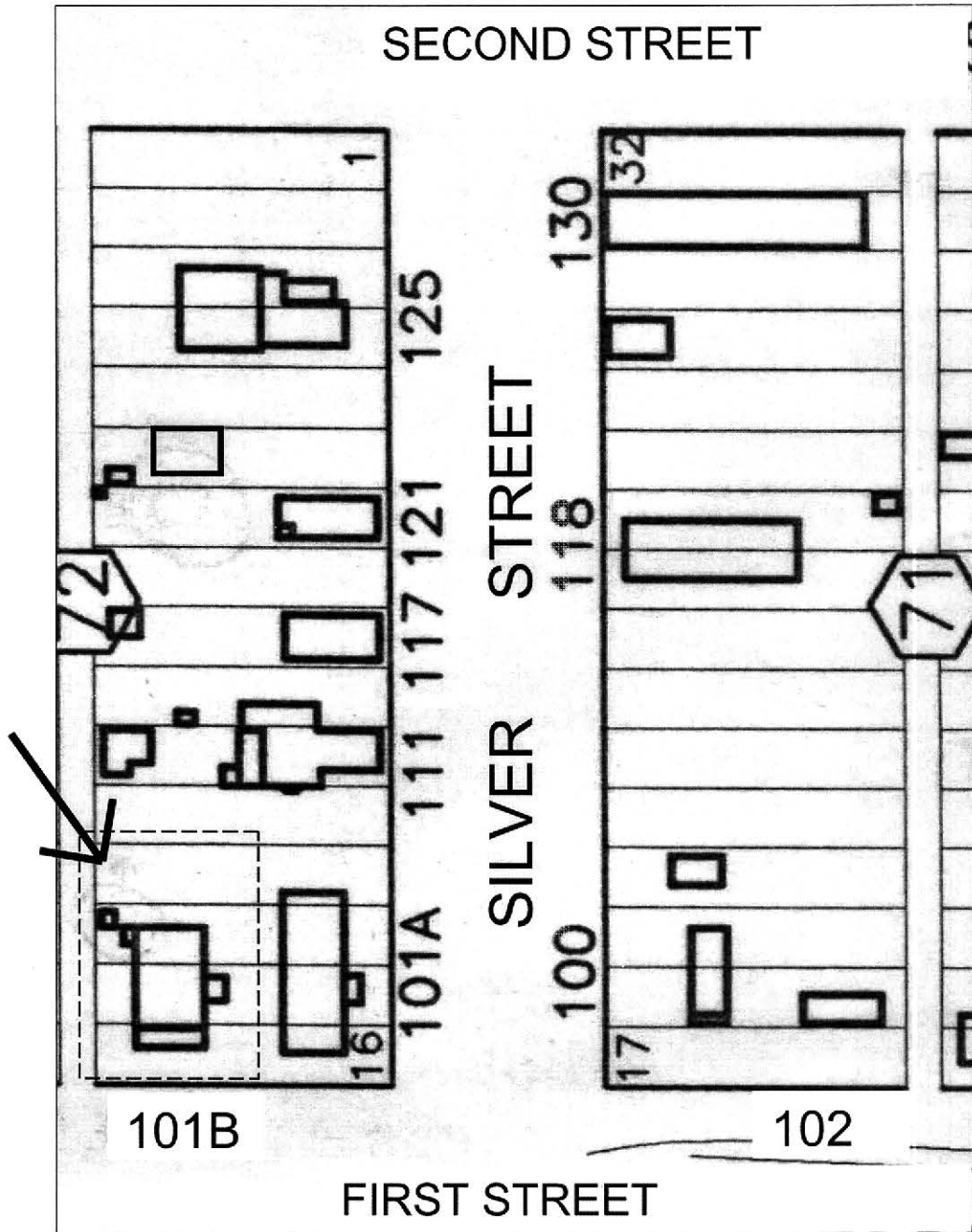

5HN68.91

101B Silver Street



5HN.68.91

9/2002



5HN.68.91

Shed 9/2002

