

SHF
S
A
B
G/H

Architectural Inventory Form

- Date _____ Initials _____
- Determined Eligible - National Register
 - Determined Not Eligible - National Register
 - Determined Eligible - State Register
 - Determined Not Eligible - State Register
 - Need Data
 - Contributes to eligible National Register District
 - Noncontributing to eligible NR District

I. Identification

1. Resource number: 5HN68.57
2. Temporary resource number: 6
3. County: Hinsdale
4. City: Lake City
5. Historic building name:
6. Current building name:
7. Building address: 205 Bluff Street, Lake City, CO 81235
8. Owner name and address: John P. Stevens, Route 16, Box 1015, Lufkin TX 75901

II. Geographic Information

9. P.M. ~~6th~~^{SW4} NM Township 44N Range 4W ^{SE4} of SW4 of SW4 of Section 27 County Property No.: R1125
10. UTM reference
Zone 13 ¹² 296520 mE 4211290 mN
11. USGS quad name: Lake City Quad year: 1985 Map scale: X 7.5' ___ 15'
12. Block(s): 0 Lot(s): 52-53 Legal:
Addition: Casco Addition Year of Addition: 1877
13. Boundary description and justification: Perimeter of parcel

III. Architectural Description

14. Building plan: Rectangular
15. Dimensions: 430 square feet
16. Number of stories: 1
17. External wall material(s): Stucco
18. Roof configuration: Front gabled
19. Roof material: Composition
20. Special features: Porch, Bay, Half-Timbering
21. General architectural description:
Modular dwelling enclosed in siding that is stuccoed with wood trim. Composition roofing. Façade has half-hipped bay window; off-center entrance with paneled and glazed door, screen door. Entrance is sheltered by a gabled entry porch with turned porch posts and plain wood balusters.
22. Architectural style/Building type: No style
23. Landscaping or special setting:
Dwelling is situated on a shallow lot at the base of the hogback.

24. Associated building, features or objects:

IV. Architectural History

25. Date of construction Estimate: 1975 Actual: _____ Source of info: Assessor's Appraisal Card

26. Architect: None Source of info:

27. Builder/contractor: Manufactured Source of info:

28. Original owner: Unknown Source of info:

29. Construction history (major additions, alterations, demolitions):

30. Original location: Moved Date of move(s) _____

V. Historical Associations

31. Original use(s): Single dwelling

32. Intermediate use(s):

33. Current use(s): Single dwelling

34. Site type(s):

35. Historical background:

36. Sources of information:

VI. Significance

37. Local landmark: Yes No Date of design.: _____ Design. authority: _____
Within Lake City Historic District (local historic district)
38. Applicable National Register Criteria:
- A. Associated with events that have made a significant contribution to the broad pattern of our history;
 - B. Associated with the lives of persons significant in our past;
 - C. Embodies the distinctive characteristics of a type, period, or method of construction, or represents the work of a master, or that possesses high artistic values, or represents a significant and distinguishable entity whose components may lack individual distinction; or
 - D. Has yielded, or may be likely to yield, information important in history or prehistory
 - Qualifies under Criteria Considerations A through G
 - Does not meet any of the above National Register criteria
39. Area(s) of significance:
40. Period of significance:
41. Level of significance: National State Local
42. Statement of significance:
This recently constructed dwelling does not contribute to the Lake City Historic District.
43. Assessment of historic physical integrity to significance:
N/A

VII. National Register Eligibility Assessment

44. National Register eligibility field assessment: Eligible Not Eligible Need Data
45. Is there National Register district potential? Yes No
Discuss _____
- If there is National Register district potential, is this building Contributing Noncontributing
46. If the building is in an existing National Register district is it? Contributing Noncontributing
(Lake City National Historic District)

VIII. Recording Information

47. Photograph numbers: Roll 1, frame 23 Negatives filed at: Lake City Town Hall
48. Report title: 2003 Architectural Survey of Lake City, Colorado
49. Date(s): September 2002 - June 2003
50. Recorders Cathleen M. Norman and Grant E. Houston
51. Organization: Town of Lake City
52. Address: 230 Bluff Street, Lake City CO 81235 53. Phone no. (970) 944-2333

Colorado Historical Society - Office of Archaeology and Historic Preservation
1300 Broadway, Denver CO 80203 (303) 866-3395

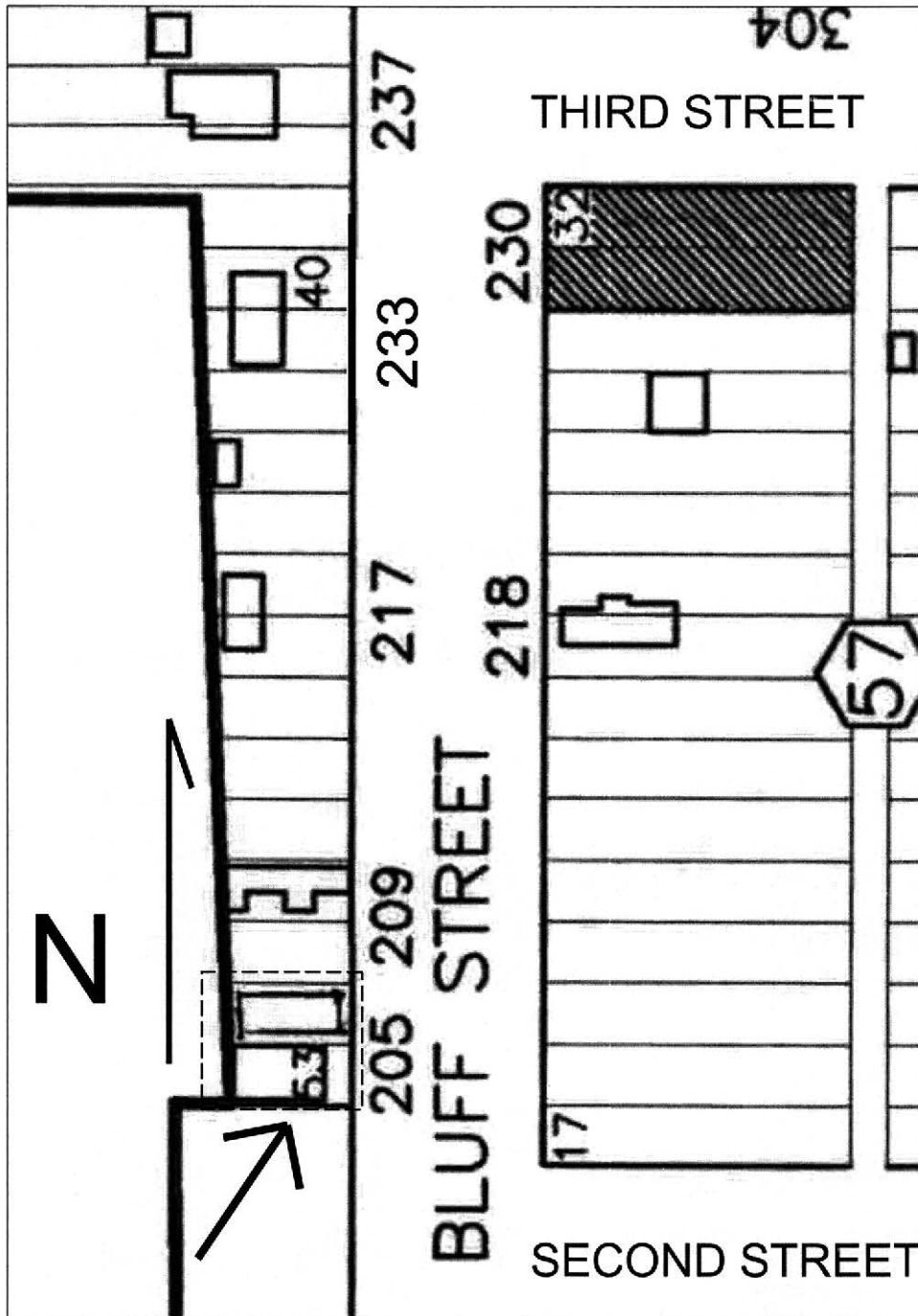

NOT TO SCALE

