

SHF
S
A
B
G
/HP

Colorado Cultural Resource Survey
Architectural Inventory Form

Official Eligibility Determination
(for OAHF use only)

- Date _____ Initials _____
- Determined Eligible - National Register
- Determined Not Eligible - National Register
- Determined Eligible - State Register
- Determined Not Eligible - State Register
- Need Data
- Contributes to eligible National Register District
- Noncontributing to eligible NR District

I. Identification

1. Resource number: 5HN68.55
2. Temporary resource number: 4
3. County: Hinsdale
4. City: Lake City
5. Historic building name: *Weeks Property*
6. Current building name: *Steele Property*
7. Building address: 120 Bluff Street, Lake City, CO 81235
8. Owner name and address: Elsie L. Steele, P.O. Box 264, Lake City CO 81235

II. Geographic Information

County Property No.: R1293

9. P.M. *6th NM* Township 44N Range 4W NE4 of NW4 of NW4 of Section 34
10. UTM reference
Zone 13 *9* 296540 mE *3* 4211200 mN
11. USGS quad name: Lake City Quad year: 1985 Map scale: X 7.5' ___ 15'
12. Block(s): 72 Lot(s): 26-28 Legal:
Addition: Year of Addition: 0
13. Boundary description and justification: Perimeter of parcel

III. Architectural Description

14. Building plan: Irregular
15. Dimensions: 840 square feet
16. Number of stories: 1
17. External wall material(s) Wood *vertical* horizontal-siding
18. Roof configuration: Front gabled
19. Roof material: Metal
20. Special features: Balcony, attached garage, fence
21. General architectural description:
1-1/2 story frame, front-gabled dwelling. Metal roof; balcony with door flanked by windows in west gable end. Exterior of vertical wood siding. Concrete foundation. Deck wraps around façade and south elevation, has plain wood balusters and railing. Attached, gabled garage on rear.
22. Architectural style/Building type No style
23. Landscaping or special setting:
Property enclosed in two-rail pole fence.

24. Associated building, features or objects:

IV. Architectural History

25. Date of construction Estimate: 1986 Actual: _____ Source of info: Assessor's Appraisal Card
26. Architect: None Source of info:
27. Builder/contractor: Bob Weeks Source of info:
28. Original owner: Weeks family Source of info:
29. Construction history (major additions, alterations, demolitions):
30. Original location: Moved Date of move(s) _____

V. Historical Associations

31. Original use(s): Single dwelling
32. Intermediate use(s):
33. Current use(s): Single dwelling
34. Site type(s):
35. Historical background:
36. Sources of information:

VI. Significance

37. Local landmark: Yes No Date of design.: _____ Design. authority: _____
Within Lake City Historic District (local historic district)
38. Applicable National Register Criteria:
- A. Associated with events that have made a significant contribution to the broad pattern of our history;
- B. Associated with the lives of persons significant in our past;
- C. Embodies the distinctive characteristics of a type, period, or method of construction, or represents the work of a master, or that possesses high artistic values, or represents a significant and distinguishable entity whose components may lack individual distinction; or
- D. Has yielded, or may be likely to yield, information important in history or prehistory
- Qualifies under Criteria Considerations A through G
- Does not meet any of the above National Register criteria
39. Area(s) of significance:
40. Period of significance:
41. Level of significance: National State Local
42. Statement of significance:
This recently constructed dwelling does not contribute to the Lake City Historic District.
43. Assessment of historic physical integrity to significance:
N/A

VII. National Register Eligibility Assessment

44. National Register eligibility field assessment: Eligible Not Eligible Need Data
45. Is there National Register district potential? Yes No
Discuss _____
- If there is National Register district potential, is this building Contributing Noncontributing
46. If the building is in an existing National Register district is it? Contributing Noncontributing
(Lake City National Historic District)

VIII. Recording Information

47. Photograph numbers: Roll 1, frame 19 Negatives filed at: Lake City Town Hall
48. Report title: 2003 Architectural Survey of Lake City, Colorado
49. Date(s): September 2002 - June 2003
50. Recorders Cathleen M. Norman and Grant E. Houston
51. Organization: Town of Lake City
52. Address: 230 Bluff Street, Lake City CO 81235 53. Phone no. (970) 944-2333

Colorado Historical Society - Office of Archaeology and Historic Preservation
1300 Broadway, Denver CO 80203 (303) 866-3395

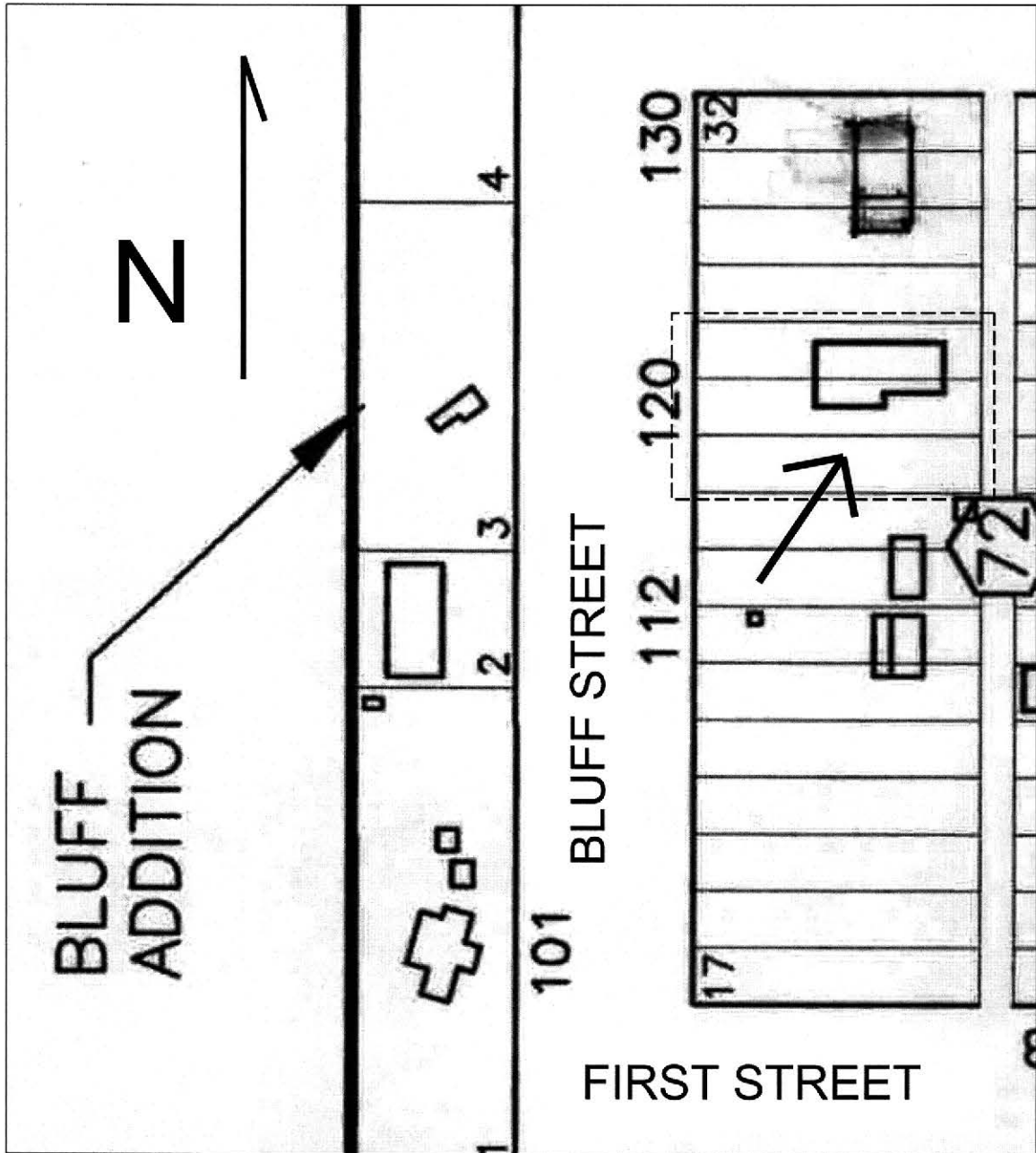

NOT TO SCALE

