

SHF
S
A
B
G
/HA

Architectural Inventory Form

Official Eligibility Determination
(for OAHP use only)

- Date _____ Initials _____
- Determined Eligible - National Register
 - Determined Not Eligible - National Register
 - Determined Eligible - State Register
 - Determined Not Eligible - State Register
 - Need Data
 - Contributes to eligible National Register District
 - Noncontributing to eligible NR District

I. Identification

1. Resource number: 5HN68.81
2. Temporary resource number: 35
3. County: Hinsdale
4. City: Lake City
5. Historic building name: Drake Property
6. Current building name:
7. Building address: 610 Bluff Street, Lake City, CO 81235
8. Owner name and address: Arthur and Virginia Nicholson, P.O. Box 433 , Lake City CO 81235

II. Geographic Information

County Property No.: R1150

9. P.M. 6th N M Township 44N Range 4W SE4 of NE4 of NW4 of SW4 of Section 27
10. UTM reference
Zone 13 296817 mE 4211837 mN
11. USGS quad name: Lake City Quad year: 1985 Map scale: X 7.5' ___ 15'
12. Block(s): 25 Lot(s): 22-23 Legal:
Addition: Year of Addition: 0
13. Boundary description and justification: Perimeter of parcel

III. Architectural Description

14. Building plan: Rectangular
15. Dimensions: 1048 square feet
16. Number of stories: 1
17. External wall material(s): Wood
18. Roof configuration: Front gabled
19. Roof material: Metal
20. Special features: Porch, ~~garage~~
21. General architectural description:
One-story, front-gabled frame dwelling. Metal roof with exposed rafters and projecting beams in gable end. Walls clad in hardboard. Windows are covered in shutters. Off-center entrance is sheltered by shallow gabled entry cover and accessed by a deck. Half-hipped porch on rear has wood supports. Concrete foundation.
22. Architectural style/Building type: No style
23. Landscaping or special setting:

24. Associated building, features or objects:

Garage, circa 1985

One-story front-gabled frame building clad in hardboard with metal roof.

IV. Architectural History

25. Date of construction Estimate: _____ Actual: 1979 Source of info: Assessor's Appraisal Card

26. Architect: None Source of info:

27. Builder/contractor: Unknown Source of info:

28. Original owner: Drake family Source of info: Assessor's Appraisal Card

29. Construction history (major additions, alterations, demolitions):

30. Original location: Moved Date of move(s) _____

V. Historical Associations

31. Original use(s): Seasonal dwelling

32. Intermediate use(s):

33. Current use(s): Seasonal dwelling

34. Site type(s):

35. Historical background:

36. Sources of information:

VI. Significance

37. Local landmark: Yes No Date of design.: _____ Design. authority: _____
Within Lake City Historic District (local historic district)
38. Applicable National Register Criteria:
- A. Associated with events that have made a significant contribution to the broad pattern of our history;
 - B. Associated with the lives of persons significant in our past;
 - C. Embodies the distinctive characteristics of a type, period, or method of construction, or represents the work of a master, or that possesses high artistic values, or represents a significant and distinguishable entity whose components may lack individual distinction; or
 - D. Has yielded, or may be likely to yield, information important in history or prehistory
 - Qualifies under Criteria Considerations A through G
 - Does not meet any of the above National Register criteria
39. Area(s) of significance:
40. Period of significance:
41. Level of significance: National State Local
42. Statement of significance:
This recently constructed house does not meet the National Register criteria for age, however it is representative of the summer dwellings constructed in Lake City from the mid 1900s on, as reflected in its stained wood siding and functional shutters.
43. Assessment of historic physical integrity to significance:

VII. National Register Eligibility Assessment

44. National Register eligibility field assessment: Eligible Not Eligible Need Data
45. Is there National Register district potential? Yes No
Discuss _____
- If there is National Register district potential, is this building Contributing Noncontributing
46. If the building is in an existing National Register district is it? Contributing Noncontributing
(Lake City National Historic District)

VIII. Recording Information

47. Photograph numbers: Roll 9, frame 17 Negatives filed at: Lake City Town Hall
48. Report title: 2003 Architectural Survey of Lake City, Colorado
49. Date(s): September 2002 - June 2003
50. Recorders Cathleen M. Norman and Grant E. Houston
51. Organization: Town of Lake City
52. Address: 230 Bluff Street, Lake City CO 81235 53. Phone no. (970) 944-2333

Colorado Historical Society - Office of Archaeology and Historic Preservation
1300 Broadway, Denver CO 80203 (303) 866-3395

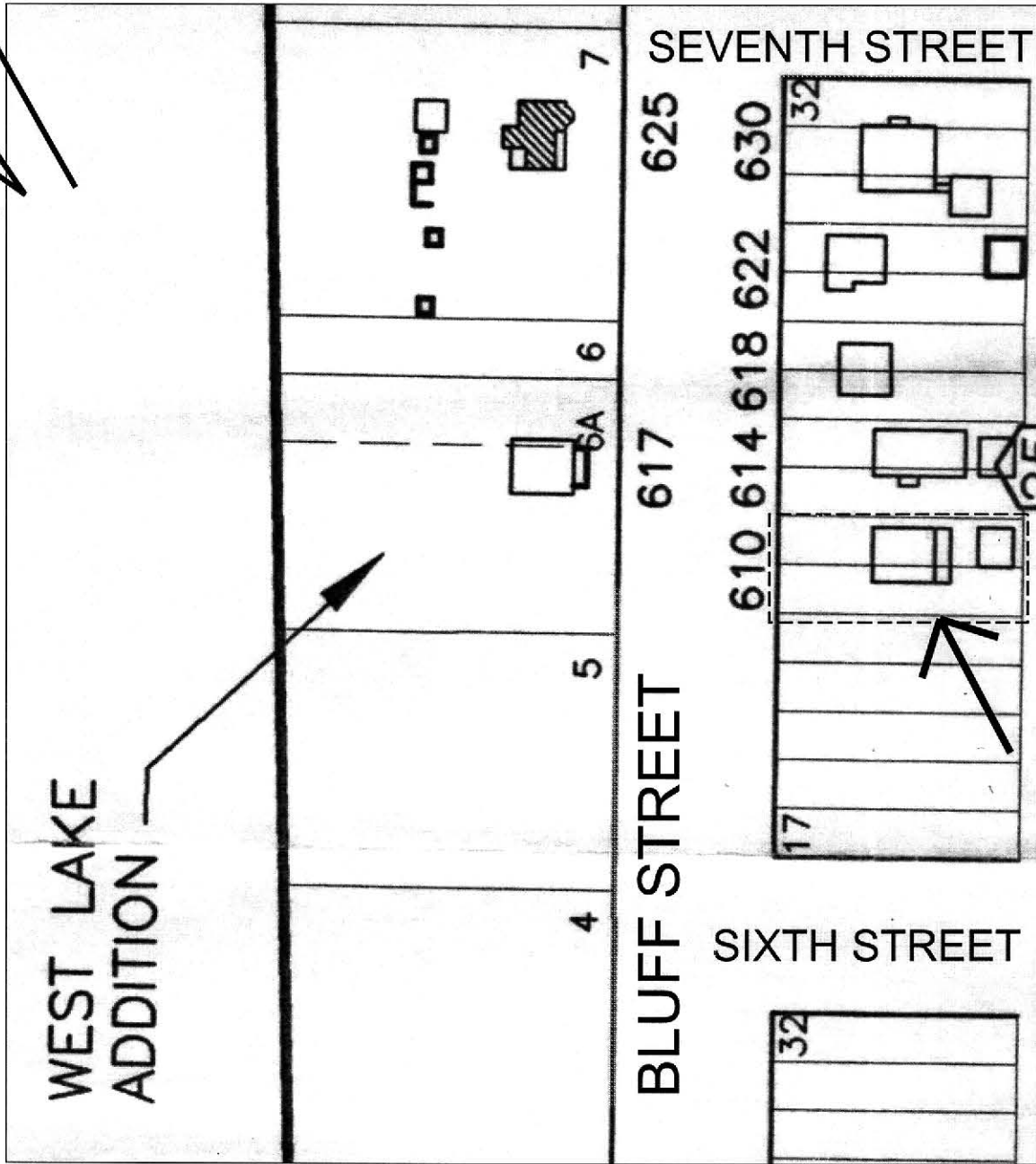
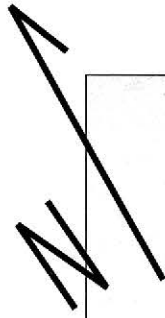

5HN68.81

610 Bluff Street



5HN. 68.81

9/2002