

SHF
S
A
B
C/A

Architectural Inventory Form

Official Eligibility Determination
(for OAHP use only)

- Date _____ Initials _____
- Determined Eligible - National Register
 - Determined Not Eligible - National Register
 - Determined Eligible - State Register
 - Determined Not Eligible - State Register
 - Need Data
 - Contributes to eligible National Register District
 - Noncontributing to eligible NR District

I. Identification

1. Resource number: 5HN68.73
2. Temporary resource number: 24
3. County: Hinsdale
4. City: Lake City
5. Historic building name: *Edmonson Fellowship Hall*
6. Current building name: Baptist Fellowship Hall
7. Building address: 400 Bluff Street, Lake City, CO 81235
8. Owner name and address: First Baptist Church, P.O. Box 515, Lake City CO 81235

II. Geographic Information

- County Property No.: RTax exempt
9. P.M. *8th NM* Township 44N Range 4W NW4 of NE4 of SW4 of SW4 of Section 27
 10. UTM reference
Zone 13 296680⁷³ mE 4211550⁴⁰ mN
 11. USGS quad name: Lake City Quad year: 1985 Map scale: X 7.5' ___ 15'
 12. Block(s): 41 Lot(s): 17-19 Legal:
Addition: Year of Addition: 0
 13. Boundary description and justification: Perimeter of parcel

III. Architectural Description

14. Building plan: Irregular
15. Dimensions: 1902 square feet
16. Number of stories: 1
17. External wall material(s): Wood horizontal siding
18. Roof configuration: Cross gabled
19. Roof material: Metal
20. Special features: Porch, decorative shingles, stained glass
21. General architectural description:
One-story cross-gabled frame dwelling with metal roof. Walls clad in narrow horizontal siding; gable ends clad in fish scale shingles. Small, round stained glass windows with dove and cross motif in north and south gable ends. Gabled vestibule centered in façade has a solid door and a round stained glass window with dove in gable end; is accessed by small, raised deck. Windows are 1-over-1, screened windows with pedimented window heads and elaborate, decorative wooden frames similar to the First Baptist Church building. Concrete foundation.
22. Architectural style/Building type: No style
23. Landscaping or special setting:

24. Associated building, features or objects:

IV. Architectural History

25. Date of construction Estimate: _____ Actual: 1994 Source of info: Assessor Appraisal Card

26. Architect: Robert Matthews Source of info:

27. Builder/contractor: Baptist volunteers Source of info:

28. Original owner: Lake City Baptist Church Source of info:

29. Construction history (major additions, alterations, demolitions):

30. Original location: Moved Date of move(s) _____

V. Historical Associations

31. Original use(s): Meeting hall

32. Intermediate use(s):

33. Current use(s): Meeting hall

34. Site type(s):

35. Historical background:

36. Sources of information:

VI. Significance

37. Local landmark: Yes No Date of design.: _____ Design. authority: _____
Within Lake City Historic District (local historic district)
38. Applicable National Register Criteria:
- A. Associated with events that have made a significant contribution to the broad pattern of our history;
 - B. Associated with the lives of persons significant in our past;
 - C. Embodies the distinctive characteristics of a type, period, or method of construction, or represents the work of a master, or that possesses high artistic values, or represents a significant and distinguishable entity whose components may lack individual distinction; or
 - D. Has yielded, or may be likely to yield, information important in history or prehistory
 - Qualifies under Criteria Considerations A through G
 - Does not meet any of the above National Register criteria
39. Area(s) of significance:
40. Period of significance:
41. Level of significance: National State Local
42. Statement of significance:
This recently constructed dwelling does not contribute to the Lake City Historic District.
43. Assessment of historic physical integrity to significance:

VII. National Register Eligibility Assessment

44. National Register eligibility field assessment: Eligible Not Eligible Need Data
45. Is there National Register district potential? Yes No
- Discuss _____
- If there is National Register district potential, is this building Contributing Noncontributing
46. If the building is in an existing National Register district is it? Contributing Noncontributing
(Lake City National Historic District)

VIII. Recording Information

47. Photograph numbers: Roll 8, frames 28-29 Negatives filed at: Lake City Town Hall
48. Report title: 2003 Architectural Survey of Lake City, Colorado
49. Date(s): September 2002 - June 2003
50. Recordors Cathleen M. Norman and Grant E. Houston
51. Organization: Town of Lake City
52. Address: 230 Bluff Street, Lake City CO 81235 53. Phone no. (970) 944-2333

Colorado Historical Society - Office of Archaeology and Historic Preservation
1300 Broadway, Denver CO 80203 (303) 866-3395

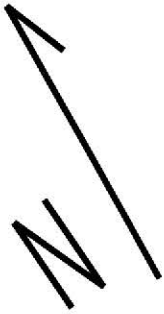

CASCO ADDITION

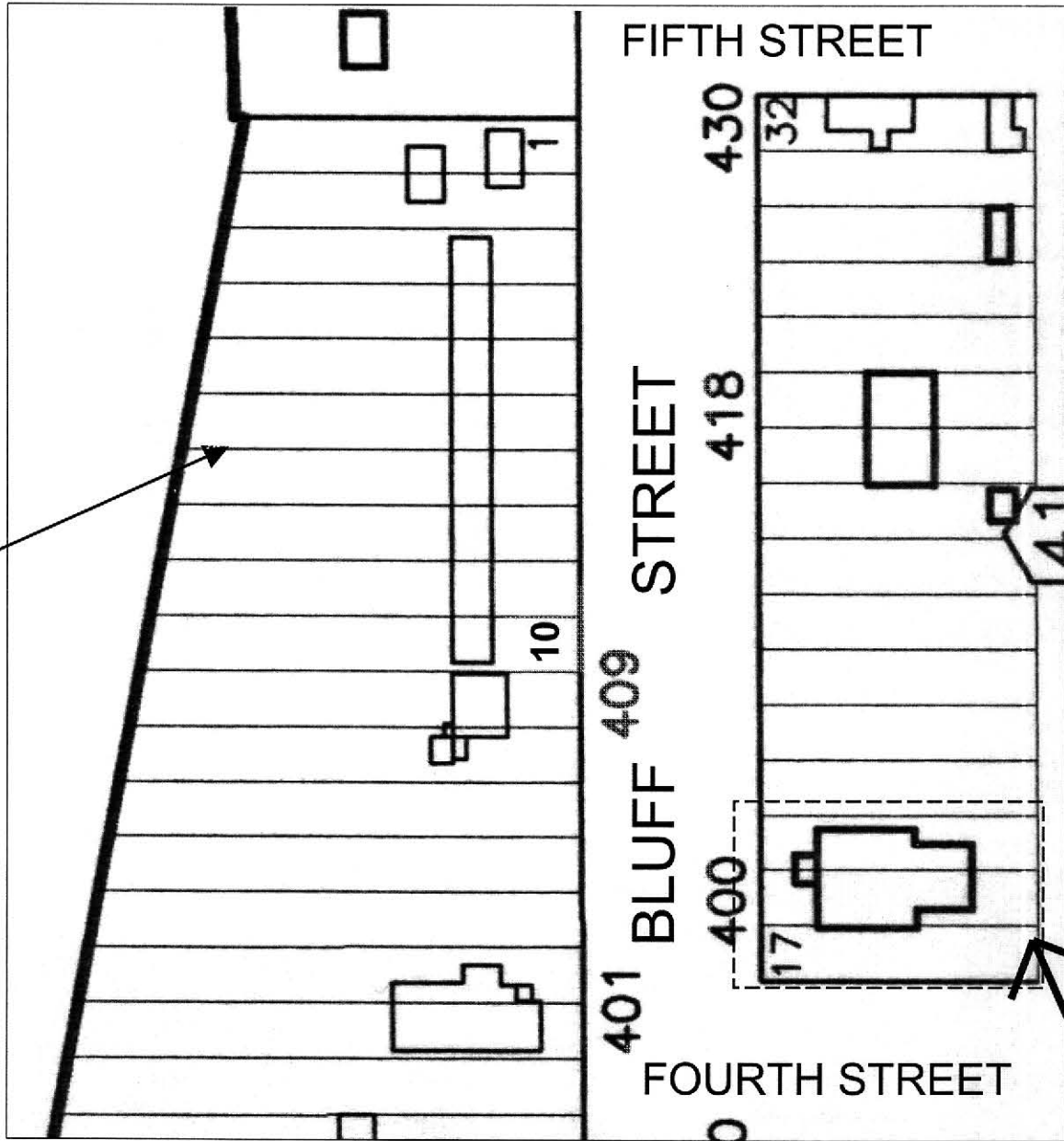

NOT TO SCALE



5HN. 08.73
5/2003



5HN. 08.73
9/2002

5HN. 68.73
9/2002

