

SHF
S
A
B
C
/4

Architectural Inventory Form

- Date _____ Initials _____
- _____ Determined Eligible - National Register
 - _____ Determined Not Eligible - National Register
 - _____ Determined Eligible - State Register
 - _____ Determined Not Eligible - State Register
 - _____ Need Data
 - _____ Contributes to eligible National Register District
 - _____ Noncontributing to eligible NR District

I. Identification

1. Resource number: 5HN68.78
2. Temporary resource number: 30
3. County: Hinsdale
4. City: Lake City
5. Historic building name: Bent ~~House~~ Mule Barn
6. Current building name: Bent Site
7. Building address: 501 Bluff Street, Lake City, CO 81235
8. Owner name and address: Harvey Thomas and Midgie Lee Murphy, P.O. Box 500 , Lake City CO 81235

II. Geographic Information

- County Property No.: R1144
9. P.M. ~~6th~~^{6th}N^M Township 44N Range 4W SW4 of SE4 of NW4 of SW4 of Section 27
 10. UTM reference
Zone 13 29666~~0~~⁶ mE 42117~~00~~⁶⁹² mN
 11. USGS quad name: Lake City Quad year: 1985 Map scale: X 7.5' ___ 15'
 12. Block(s): 0 Lot(s): 1 Legal:
Addition: West Lake Addition Year of Addition: 1883
 13. Boundary description and justification: Perimeter of parcel

III. Architectural Description

14. Building plan: Rectangular
15. Dimensions: 600 square feet
16. Number of stories: 1
17. External wall material(s): Wood, metal
18. Roof configuration: Front gabled
19. Roof material: Wood
20. Special features:
21. General architectural description:
1-~~1/2~~ story, front-gabled frame building with board roof and walls clad in vertical boards. Shed-roofed section on east side has corrugated metal and horizontal clapboards. Entrance in south elevation; opening in gable end. No visible foundation.
22. Architectural style/Building type: No style
23. Landscaping or special setting:

24. Associated building, features or objects:

The mule barn is associated with the Charles Hammond Bent house that stood at the front of the lot until it burned to the ground in 1918.

IV. Architectural History

25. Date of construction Estimate: 1905 Actual: _____ Source of info: Overview photographs, Town of Lake City, 1905, 1910, 1934
26. Architect: None Source of info:
27. Builder/contractor: Unknown Source of info:
28. Original owner: Charles Hammond Bent Source of info: SILVER WORLD
29. Construction history (major additions, alterations, demolitions):
Unaltered
30. Original location: Moved Date of move(s) _____

V. Historical Associations

31. Original use(s): Shed Barn
32. Intermediate use(s):
33. Current use(s): Shed
34. Site type(s):
35. Historical background:

This site -- located on Lot One of the 11-parcel West Lake Addition, an 1884 addition to the Town of Lake City -- is associated with Charles Hammond Bent (1838-1896) who represented Hinsdale County in the state legislature in the early 1890s. He mined and prospected in the area starting in 1875 and is recalled in present-day Bent Peak and Bent Creek on the upper Lake Fork.

He constructed a 1-1/2-story frame house at this location in 1882. It was owned by Mrs. George C. Stephen at the time it burned to the ground in 1918.

The surviving structure is what is known as the "mule barn," a gabled frame stable which is located toward the rear of Lot One at the base of Neoga Mountain. The barn is not extant in a 1900 photograph of the neighborhood, although the structure is visible in a January, 1936, photo. The site, with barn, is owned by Tom Murphy, owner of the adjoining Kennedy House on Lot Two, Westlake Addition.

36. Sources of information:

Overview photographs, Town of Lake City, 1905, 1910, 1934; CEMETERIES OF HINSDALE COUNTY, COLORADO, 1874-1996, Decorah, Iowa: Anundsen Publishing Co., 1996, page 21; SILVER WORLD, November 18, 1882, page 3, December 31, 1896, page 2, August 1, 1918, page 2.

VI. Significance

37. Local landmark: Yes No Date of design.: _____ Design. authority: _____

Within Lake City Historic District (local historic district)

38. Applicable National Register Criteria:

- A. Associated with events that have made a significant contribution to the broad pattern of our history;
- B. Associated with the lives of persons significant in our past;
- C. Embodies the distinctive characteristics of a type, period, or method of construction, or represents the work of a master, or that possesses high artistic values, or represents a significant and distinguishable entity whose components may lack individual distinction; or
- D. Has yielded, or may be likely to yield, information important in history or prehistory
- Qualifies under Criteria Considerations A through G
- Does not meet any of the above National Register criteria

39. Area(s) of significance: Social history, architecture

40. Period of significance: 1905 -1904

41. Level of significance: National State Local

42. Statement of significance:

This mule barn is representative of the variety of outbuildings constructed in Lake City in the late 19th and early 20th century, as reflected in its rectangular plan, board siding, and simple frame construction. It is associated with the residence of Charles Hammond Bent, whose residence stood at the front of this lot until it burned to the ground in 1918.

43. Assessment of historic physical integrity to significance:

Although deteriorating, the architectural integrity of this dwelling is intact, as evidenced by minimal alterations to its character-defining features.

VII. National Register Eligibility Assessment

44. National Register eligibility field assessment: Eligible Not Eligible Need Data

45. Is there National Register district potential? Yes No

Discuss _____

If there is National Register district potential, is this building Contributing Noncontributing

46. If the building is in an existing National Register district is it? Contributing Noncontributing
(Lake City National Historic District)

VIII. Recording Information

47. Photograph numbers: Roll 4, frame 5A Negatives filed at: Lake City Town Hall

48. Report title: 2003 Architectural Survey of Lake City, Colorado

49. Date(s): September 2002 - June 2003

50. Recordors Cathleen M. Norman and Grant E. Houston

51. Organization: Town of Lake City

52. Address: 230 Bluff Street, Lake City CO 81235 53. Phone no. (970) 944-2333

Colorado Historical Society - Office of Archaeology and Historic Preservation
1300 Broadway, Denver CO 80203 (303) 866-3395

NOT TO SCALE

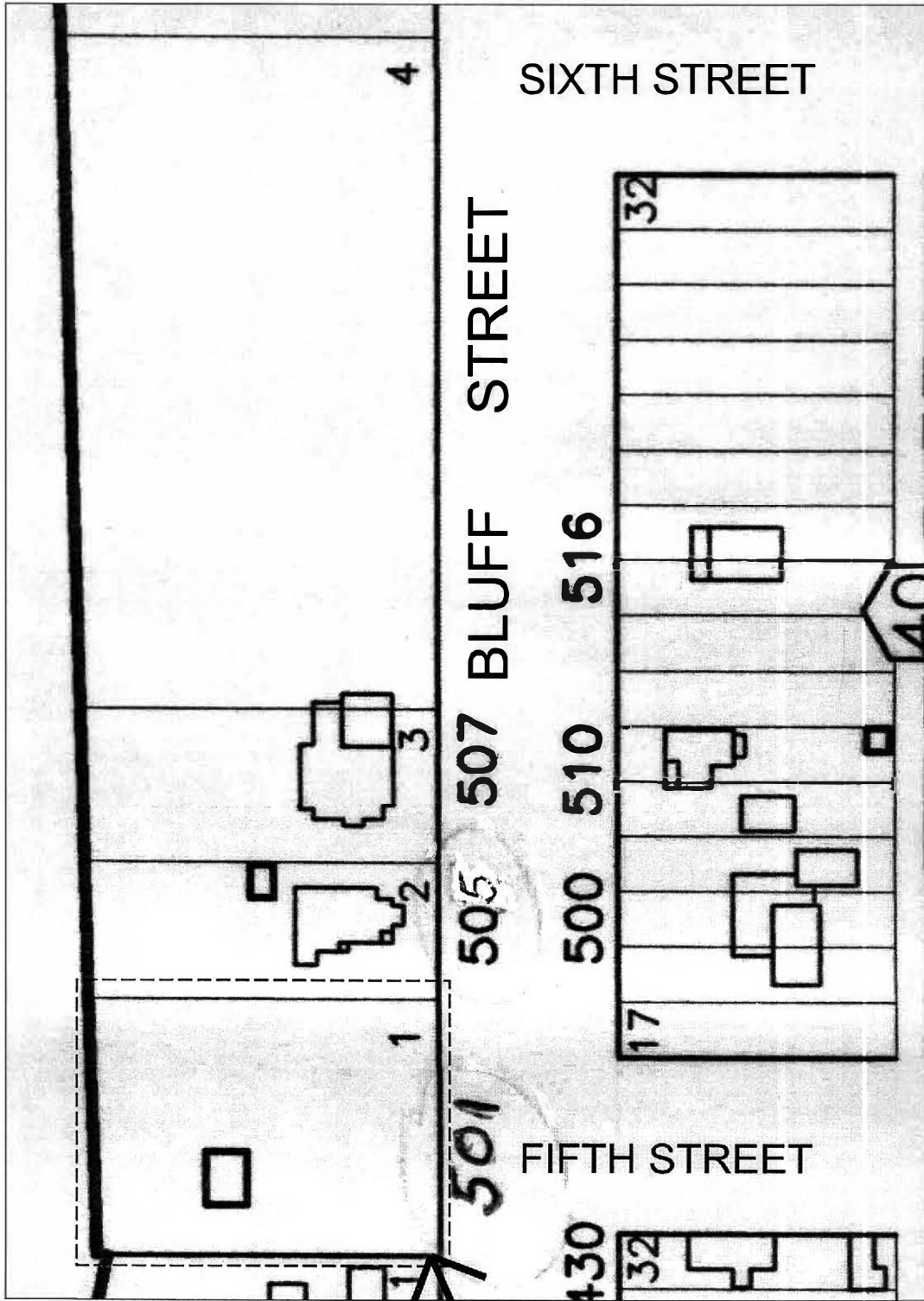
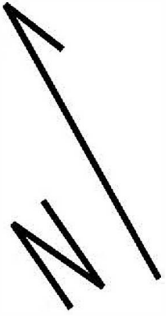

5HN68.78

501 Bluff Street



5HN.08.78
9/2002