

SHF  
S  
A  
B  
G  
/HP

# Architectural Inventory Form

## Official Eligibility Determination (for OAHP use only)

- Date \_\_\_\_\_ Initials \_\_\_\_\_
- Determined Eligible - National Register  
 Determined Not Eligible - National Register  
 Determined Eligible - State Register  
 Determined Not Eligible - State Register  
 Need Data  
 Contributes to eligible National Register District  
 Noncontributing to eligible NR District

### I. Identification

1. Resource number: 5HN68.75
2. Temporary resource number: 27
3. County: Hinsdale
4. City: Lake City
5. Historic building name: *Baptist Parsonage*
6. Current building name: Baptist Parsonage
7. Building address: 418 Bluff Street, Lake City, CO 81235
8. Owner name and address: First Baptist Church, P.O. Box 515, Lake City CO 81235

### II. Geographic Information

- County Property No.: RTax exempt
9. P.M. *6th NM* Township 44N Range 4W NW4 of NE4 of SW4 of SW4 of Section 27
  10. UTM reference  
Zone 13 *296700* mE *4211600* mN
  11. USGS quad name: Lake City Quad year: 1985 Map scale: X 7.5' 15'
  12. Block(s): 41 Lot(s): 25-28 Legal:  
Addition: Year of Addition:
  13. Boundary description and justification: Perimeter of parcel

### III. Architectural Description

14. Building plan: Rectangular
15. Dimensions: 1250 square feet
16. Number of stories: 1-1/2
17. External wall material(s): Horizontal siding
18. Roof configuration: Side gabled
19. Roof material: Metal
20. Special features: Porch, dormers, *Balcony, Attached Garage*
21. General architectural description:  
1-1/2 story, side-gabled dwelling. Metal roof with west- and east-facing gabled dormers. Walls clad in horizontal siding. Façade has full-width, inset porch with square wooden posts and plain balusters. Porch shelters centered entrance has paneled and glazed door and sidelights. Similar porch in east elevation. Windows are 6-over-6 and 4-over-4. East elevation has full-width, inset porch with square wood posts and plain baluster; shelters entrance and row of windows; east roof slope has three gabled dormers.
22. Architectural style/Building type: No style
23. Landscaping or special setting:

24. Associated building, features or objects:

Shed, 1998

Shed-roofed frame building with metal roof. Walls clad in horizontal siding with band of fish scale shingles at frieze. Short, paneled door with wood stoop

#### IV. Architectural History

25. Date of construction Estimate: \_\_\_\_\_ Actual: 1999 Source of info: Assessor Appraisal card

26. Architect: Robert Matthews Source of info:

27. Builder/contractor: David Beebe, Baptist volunteers Source of info:

28. Original owner: Lake City Baptist Church Source of info:

29. Construction history (major additions, alterations, demolitions):

30. Original location:  Moved  Date of move(s) \_\_\_\_\_

#### V. Historical Associations

31. Original use(s): Single dwelling

32. Intermediate use(s):

33. Current use(s): Single dwelling

34. Site type(s):

35. Historical background:

36. Sources of information:

## VI. Significance

37. Local landmark: Yes  No  Date of design.: \_\_\_\_\_ Design. authority: \_\_\_\_\_  
Within Lake City Historic District (local historic district)
38. Applicable National Register Criteria:
- A. Associated with events that have made a significant contribution to the broad pattern of our history;
  - B. Associated with the lives of persons significant in our past;
  - C. Embodies the distinctive characteristics of a type, period, or method of construction, or represents the work of a master, or that possesses high artistic values, or represents a significant and distinguishable entity whose components may lack individual distinction; or
  - D. Has yielded, or may be likely to yield, information important in history or prehistory
  - Qualifies under Criteria Considerations A through G
  - Does not meet any of the above National Register criteria
39. Area(s) of significance:
40. Period of significance:
41. Level of significance: National  State  Local
42. Statement of significance:  
This recently constructed dwelling does not contribute to the Lake City Historic District.
43. Assessment of historic physical integrity to significance:

## VII. National Register Eligibility Assessment

44. National Register eligibility field assessment:  Eligible  Not Eligible  Need Data
45. Is there National Register district potential?  Yes  No  
Discuss \_\_\_\_\_
- If there is National Register district potential, is this building  Contributing  Noncontributing
46. If the building is in an existing National Register district is it?  Contributing  Noncontributing  
(Lake City National Historic District)

## VIII. Recording Information

47. Photograph numbers: Roll 8, frame 30-32 Negatives filed at: Lake City Town Hall
48. Report title: 2003 Architectural Survey of Lake City, Colorado
49. Date(s): September 2002 - June 2003
50. Recorders Cathleen M. Norman and Grant E. Houston
51. Organization: Town of Lake City
52. Address: 230 Bluff Street, Lake City CO 81235 53. Phone no. (970) 944-2333

Colorado Historical Society - Office of Archaeology and Historic Preservation  
1300 Broadway, Denver CO 80203 (303) 866-3395

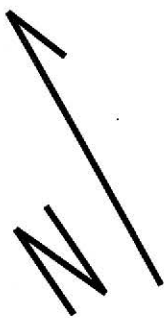

CASCO ADDITION

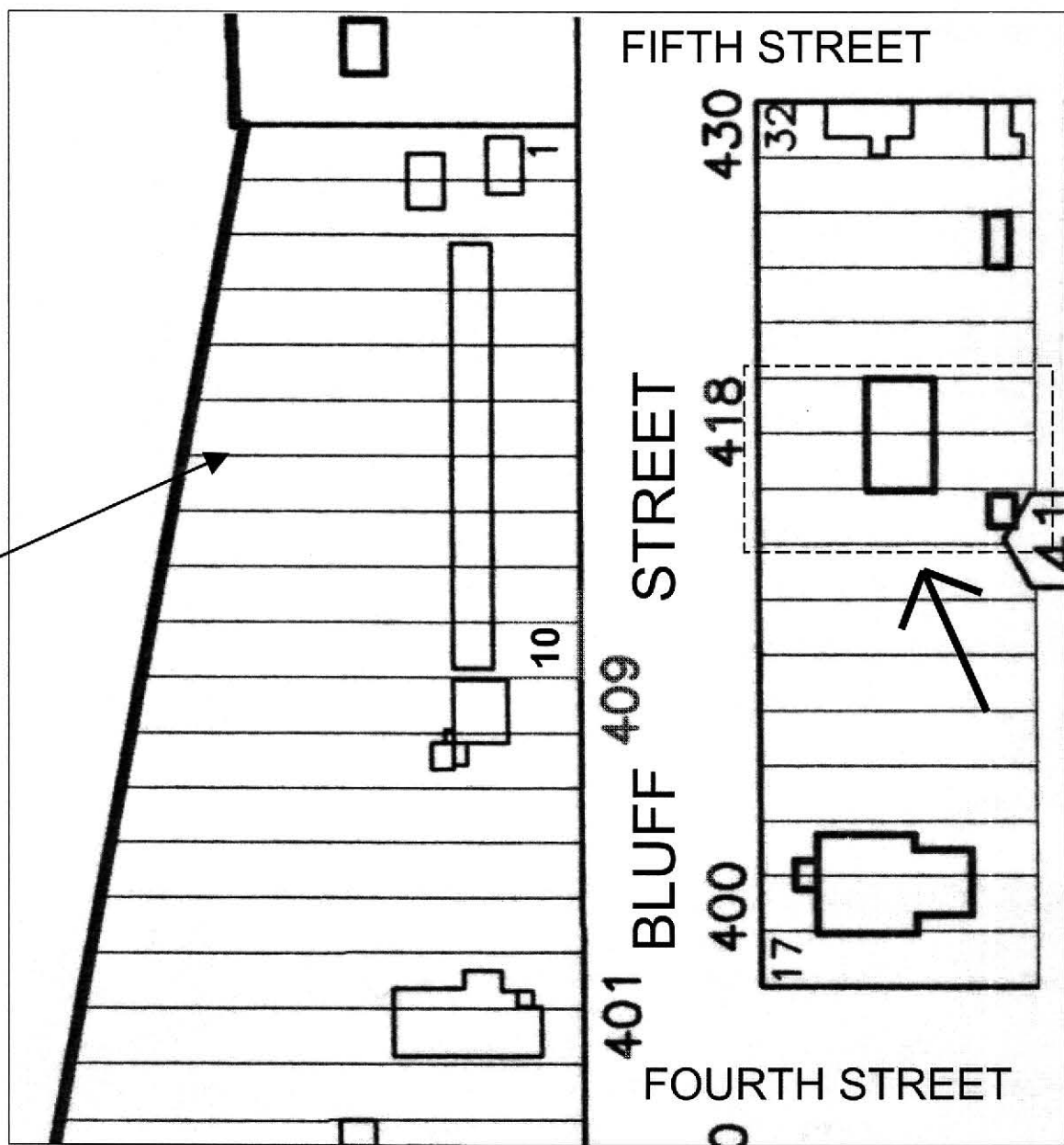

NOT TO SCALE



5HN.68.75  
9/2002





5HN.68.75  
9/2002



5HN.68.75  
Shed 9/2002