

Architectural Inventory Form

Official Eligibility Determination
(for OAHF use only)

SHR
S
OAHF

- Date _____ Initials _____
- ___ Determined Eligible - National Register
 - ___ Determined Not Eligible - National Register
 - ___ Determined Eligible - State Register
 - ___ Determined Not Eligible - State Register
 - ___ Need Data
 - ___ Contributes to eligible National Register District
 - ___ Noncontributing to eligible NR District

I. Identification

1. Resource number: 5HN68.127^{.26}
2. Temporary resource number: 103
3. County: Hinsdale
4. City: Lake City
5. Historic building name: Hinsdale County School
6. Current building name: ~~Hinsdale County School~~ Lake City Community School
7. Building address: 614 Silver Street, Lake City, CO 81235
8. Owner name and address: Hinsdale County School, P.O. Box 277, Lake City CO 81235

N.H.G. Heath Middle School
Edna Knowlton Ramsey Elementary

II. Geographic Information

County Property No.: RTax exempt

9. P.M. ~~6th~~^{6th} NM Township 44N Range 4W NW4 of SW4 of NW4 of SW4 of Section 27
10. UTM reference
Zone 13 296900²⁰ mE 4211780⁷⁴ mN
11. USGS quad name: Lake City Quad year: 1985 Map scale: X 7.5' ___ 15'
12. Block(s): 26 Lot(s): 7-28 Legal:
Addition: Year of Addition:
13. Boundary description and justification: Perimeter of parcel

III. Architectural Description

14. Building plan: Irregular
15. Dimensions: 13000 square feet
16. Number of stories: 1
17. External wall material(s): Brick, horizontal siding
18. Roof configuration: Side gabled, hipped
19. Roof material: Metal
20. Special features: Porches, segmental arches, cupola
21. General architectural description:

Large one- and 1-1/2 story building composed of multiple sections. Metal roof; east and south elevations clad in red brick; other elevations clad in red brick on lower wall, vinyl siding on upper.

North section is rectangular oriented east-west, has a side-gabled roof with clipped gable ends. In the northwest corner of the east-facing "U" is a small, square-plan, two-story, hipped-roof section clad in lapped vinyl siding; mounted roof apex is an elaborate cupola/clock tower with Mansard roof covered in fish scale and diamond shingles, from stable in Cheyenne, Wyoming (see Historic Associations).

South section is approximately square, has a side-gabled roof with a hipped section on east with clipped gable. On south elevation and at northeast corner of south section is a half-hipped entry porch with clipped gable end, supported by square posts with bases and capitals. North roof edge extends to create a covered outdoor corridor; supported by square posts.

West section connects the north and south sections, has a side gabled roof with clipped gables. Half-hipped entry cover with clipped gables on west elevation.

East elevations have paired 1-over-1 windows with segmental arches; entrance with segmental arch and 9-lite paneled and glazed door. Other windows are 1-over-1 single, paired and in rows.

22. Architectural style/Building type: No style

23. Landscaping or special setting:

Located on a large site composed of the south portion of Block 26. Mature cottonwoods along the edge of Gunnison Avenue and Silver Street. At southeast corner of the property are two carved relief sandstone signs, "1880" and "Public School" which were successively salvaged from the original 1880 and 1949 remodel buildings, and incorporated into a modern brick sign at the southeast corner of the school property fronting Gunnison Avenue, Sixth Street, and Silver Street.

24. Associated building, features or objects:

IV. Architectural History

25. Date of construction Estimate: _____ Actual: 1987 Source of info: Lake City SILVER WORLD

26. Architect: SunDesigns Architects Source of info: Lake City SILVER WORLD

27. Builder/contractor: Unknown Source of info:

28. Original owner: Hinsdale County School District RE-1 Source of info: Lake City SILVER WORLD

29. Construction history (major additions, alterations, demolitions):

A 13,000-square foot expansion which was completed in 2003.

30. Original location: Moved Date of move(s) _____

V. Historical Associations

31. Original use(s): Education

32. Intermediate use(s):

33. Current use(s): Education

34. Site type(s):

35. Historical background:

Hinsdale County School District RE-1 was formed in 1876 and throughout the latter 1870s utilized rental quarters in commercial buildings (including St. James Episcopal Church, 501 Gunnison Avenue) for public school classes. Efforts began in 1880, however, to improve the image of Lake City and vitalize the economy by attracting young families with children by construction of a sizeable brick school building. The school district began acquiring lots on the south end of Block 26, a process which required demolition or moving of several residences which had been built in the area.

Prominent Denver architect Robert S. Roeschlaub, who designed the Central City Opera and numerous Denver area buildings, drew plans for the two-story Italianate style brick building. The schoolhouse accommodated two large classrooms for up to 112 primary and elementary students on the lower floor and an upstairs area with classrooms for 110 high school students and two recitation rooms.

The new school was completed in 1881 and almost immediately experienced structural problems because of the extreme weight of the 2-1/2-story brick building built on unstable, wet soils. A subtle shifting of the building resulted in broken floor joists and a large crack in the threshold stone, the latter visible in photos by the mid-1890s. A diminishing number of school students continued to use the school building until the latter 1940s when the building was condemned. A 1949 remodeling resulted in a total rebuild of the lower story and removal of the second story. Bricks of the remodeled 1-1/2-story school were covered with stucco, only the old stone foundation remaining original to the 1880 Roeschlaub construction. The remodeled school was itself demolished in May, 1987, when it was replaced by the new H.G. Heath Elementary School, a \$414,000 structure designed by SunDesigns Architects of Glenwood Springs, Colorado.

An architectural artifact used in the school's construction is the prominent cupola, built in 1884 and used as a ventilator and ornament on the stable of the Hiram Kelly residence in Cheyenne, Wyoming. The stable was demolished in the 1960s and the cupola acquired and brought to Lake City in 1979.

Lake City Community School, with wings for H.G. Heath Middle School and High School, and Edna Knowlton Ramsey Elementary, received a 13,000-square foot expansion which was completed in 2003

36. Sources of information:

VI. Significance

37. Local landmark: Yes No Date of design.: _____ Design. authority: _____

Within Lake City Historic District (local historic district)

38. Applicable National Register Criteria:

A. Associated with events that have made a significant contribution to the broad pattern of our history;

B. Associated with the lives of persons significant in our past;

C. Embodies the distinctive characteristics of a type, period, or method of construction, or represents the work of a master, or that possesses high artistic values, or represents a significant and distinguishable entity whose components may lack individual distinction; or

D. Has yielded, or may be likely to yield, information important in history or prehistory

Qualifies under Criteria Considerations A through G

Does not meet any of the above National Register criteria

39. Area(s) of significance:

40. Period of significance:

41. Level of significance: National State Local

42. Statement of significance:

This recently constructed building does not contribute to the Lake City Historic District.

43. Assessment of historic physical integrity to significance:

VII. National Register Eligibility Assessment

44. National Register eligibility field assessment: Eligible Not Eligible Need Data

45. Is there National Register district potential? Yes No

Discuss _____

If there is National Register district potential, is this building Contributing Noncontributing

46. If the building is in an existing National Register district is it? Contributing Noncontributing
(Lake City National Historic District)

VIII. Recording Information

47. Photograph numbers: Roll 8, frames 9-10, 23; Roll 31, frames 6A - 10A, 16A - 18A, 20A - 23A
Negatives filed at: Lake City Town Hall

48. Report title: 2003 Architectural Survey of Lake City, Colorado

49. Date(s): September 2002 - June 2003

50. Recordors Cathleen M. Norman and Grant E. Houston

51. Organization: Town of Lake City

52. Address: 230 Bluff Street, Lake City CO 81235

53. Phone no. (970) 944-2333

Colorado Historical Society - Office of Archaeology and Historic Preservation
1300 Broadway, Denver CO 80203 (303) 866-3395

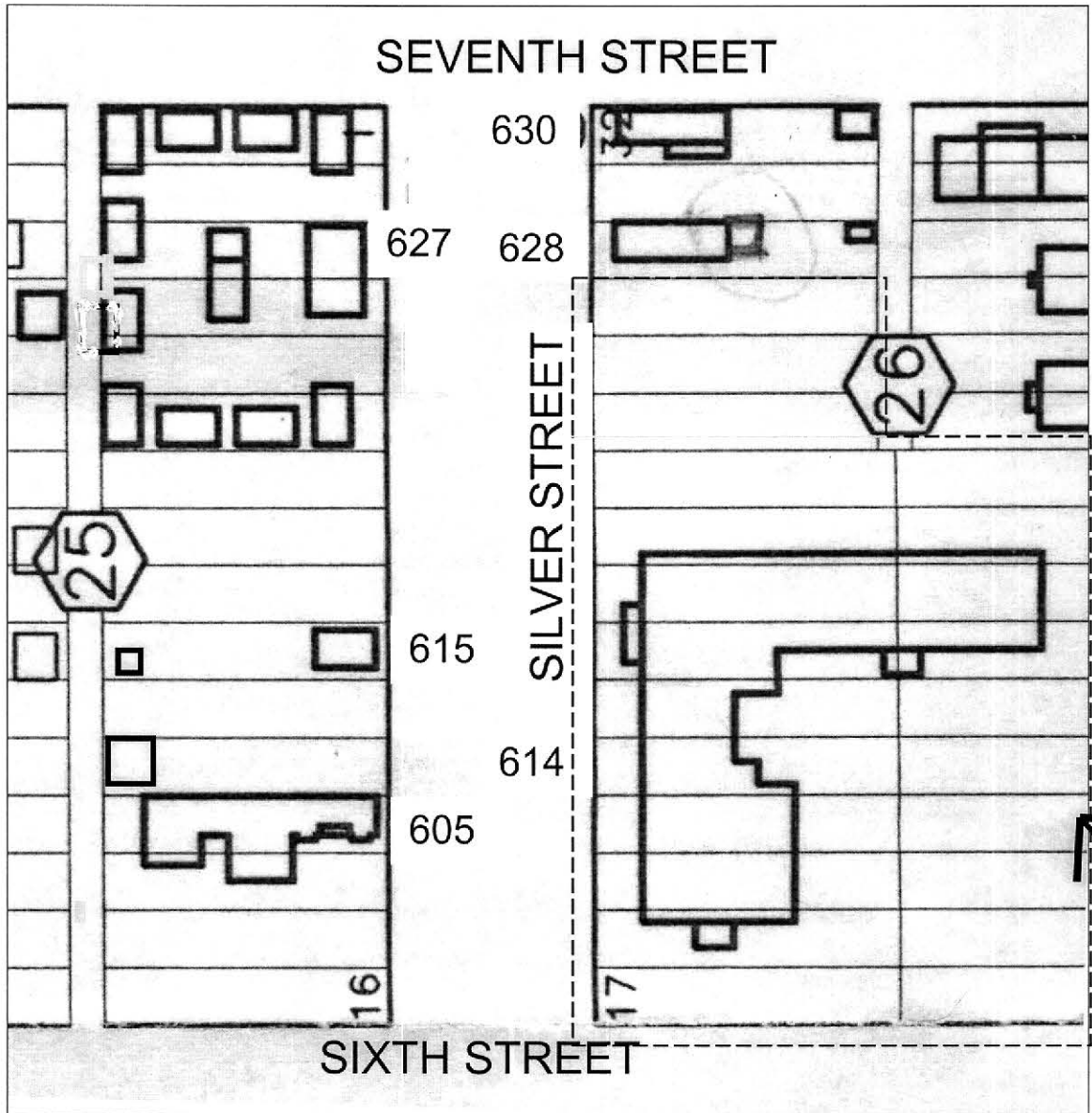

NOT TO SCALE

5HN68.127²⁶

614 Silver Street



SHN. 08.26
5/2003





5HN.68.26
5/2003





5HN.68.26
5/2003





SHN. 68.26
5/2003

5HN.68.26
5/2003



5HN.68.26
9/2002





5HN.68.26
9/2002





5HN.68.26
9/2002

