

SHF  
S  
A  
B  
G/HP

# Architectural Inventory Form

Official Eligibility Determination  
(for OAHP use only)

- Date \_\_\_\_\_ Initials \_\_\_\_\_
- \_\_\_\_\_ Determined Eligible - National Register
  - \_\_\_\_\_ Determined Not Eligible - National Register
  - \_\_\_\_\_ Determined Eligible - State Register
  - \_\_\_\_\_ Determined Not Eligible - State Register
  - \_\_\_\_\_ Need Data
  - \_\_\_\_\_ Contributes to eligible National Register District
  - \_\_\_\_\_ Noncontributing to eligible NR District

## I. Identification

.127

1. Resource number: 5HN68.15
2. Temporary resource number: 102
3. County: Hinsdale
4. City: Lake City
5. Historic building name: Whinnery-Carris House
6. Current building name:
7. Building address: 605 Silver Street, Lake City, CO 81235
8. Owner name and address: Stephen Johns, Aldene Caley Herman, and Robert Johns, 7379-B South Hulen, Fort Worth TX 76133

## II. Geographic Information

County Property No.: R1068

9. P.M. 6th NM Township 44N Range 4W NE4 of SE4 of NW4 of SW4 of Section 27
10. UTM reference  
Zone 13 296830<sup>8</sup> mE 4211790<sup>2</sup> mN
11. USGS quad name: Lake City Quad year: 1985 Map scale: X 7.5' \_\_\_ 15'
12. Block(s): 25 Lot(s): 11-16 Legal:  
Addition: Year of Addition:
13. Boundary description and justification: Perimeter of parcel

## III. Architectural Description

14. Building plan: Irregular
15. Dimensions: 1849 square feet
16. Number of stories: 1
17. External wall material(s): Horizontal siding
18. Roof configuration: ~~Front gabled~~ side gabled
19. Roof material: Composition
20. Special features: Porch, garage, bays
21. General architectural description:

One-story frame dwelling with double front gables connected by a side gable. Composition roofing. Clad in wide, horizontal siding. Each gable end contains a shallow bay window with half hipped roof with flare eaves; bays contain metalframe slider windows. Inset porch has off-center entrance with paneled and glazed door and screen door. Flat-roofed addition built in 1960 at southwest corner has similar siding, exposed rafter ends, and metalframe slider windows. Stone foundation. Gabled, two-car garage attached at southwest corner.

22. Architectural style/Building type: No style
23. Landscaping or special setting:  
Property occupies large, prominent corner site. The dwelling's deep setback creates large yard.

24. Associated building, features or objects:

Shed, circa 1970

One-story shed-roofed building clad in boards. Corrugated metal roof has exposed rafter ends. Board door. Concrete foundation.

#### IV. Architectural History

25. Date of construction Estimate: \_\_\_\_\_ Actual: 1893 Source of info: Hinsdale County Tax Rolls, 1893-1940; Hinsdale County Tax Rolls, 1893-1940  
19, 1893, page 3, November 9, 1893, page 3, November 23, 1893, page 3.
26. Architect: Unknown Source of info:
27. Builder/contractor: Unknown *Possibly F.A. Thompson* Source of info:
28. Original owner: Webster S. Whinnery Source of info: Hinsdale County Tax Rolls, 1893-1940
29. Construction history (major additions, alterations, demolitions):  
272 square-foot addition built on west in 1957. Wide horizontal siding, apparently aluminum applied and 560 square-foot, flat-roofed addition built on southwest in 1960. Front-gabled garage built on west in 1970 with attached section to main house. (source: Tax Assessor Appraisal Card)
30. Original location:  Moved  Date of move(s) \_\_\_\_\_

#### V. Historical Associations

31. Original use(s): Single dwelling
32. Intermediate use(s):
33. Current use(s): Seasonal dwelling
34. Site type(s):
35. Historical background:

Only a handful of late 19th Century residents are identified with multiple buildings within the Lake City National Historic District, the principals being Henry A. Avery (one extant residence, four business buildings), John S. Hough (one extant residence, three business buildings), and Webster S. Whinnery, a prominent Lake Fork Valley rancher and businessman who constructed this residence in 1893. In addition to 605 Silver Street, Whinnery built or is closely associated with three other residences in the Lake City Historic District (513 Silver Street, 531 Gunnison Avenue, and 510 Bluff Street), and occupied two extant historic business buildings (301 Silver Street and 300 Third Street).

Known variously as "Cattle Prince of the Lake Fork," "Tall Sycamore of the Lake Fork," and "Mr. Republican," Webster S. Whinnery was born at Salem, Ohio, in 1865 and came west with his parents in the early 1870s. His father, John E. Whinnery (1829-1913), moved his family to Saguache, Colorado, in the early 1870s and was among the prospectors called on to bury the victims of Alferd Packer above Lake City in August, 1874. The elder Mr. Whinnery filed on 640 acres on the lower Lake Fork, located in Gunnison County near the Gunnison-Hinsdale county line, in 1879. He grazed cattle on the land until 1885 when he relocated to Read in Delta, County, turning the Lake Fork ranch over to his son, Web Whinnery. Through Webb Whinnery's efforts, the ranch ultimately grew to over 3,000 acres and 600 head of cattle.

John Whinnery and his son, Webb, began marketing dairy products to booming Lake City in the early 1880s under the title "J.E. Whinnery & Son". As successor to the firm, Webster Whinnery bought Albert Greenfield's Miners' Meat Market in 1888 and gradually expanded the butcher shop business to encompass groceries, produce and miners supplies. Whinnery operated the business solely, the exceptions being 1888 when he was in partnership with John L. Murphy and 1892-1895 when he was associated with Charles L. Sweet. The Whinnery business operated in four downtown Lake City buildings between 1888 and 1918 when Whinnery & Co. officially closed. In addition to his business interests, Webster Whinnery owned many silver mines in the vicinity, the best known being the St. Jacobs at Carson. A staunch Republican, he was elected to a single term in the Colorado Legislature in 1902 and was nominated four times as Republican challenger to Democrat Edward Taylor in the Fourth Congressional District. Webb Whinnery later made his home in Gunnison, Colorado, dying a few days

short of his 102nd birthday in June, 1967.

The frame house at 605 Silver Street was Web Whinnery's first Lake City residence, a home he occupied as he divided his time between Lake City and his lower Lake Fork ranch. Work on the residence began in October, 1893, and was completed in January, 1894, at which time the Lake City TIMES noted the residence "adds much to the appearance of that part of town... it is very cosy and homelike." Whinnery completed an addition to the home in 1895 and in 1894 built a two-story barn adjoining the residence, the latter destroyed in a September, 1921, fire.

Whinnery lived at 605 Silver Street as a bachelor, with his sister, Eva Whinnery (later Eva Seely, 1871-1956), assisting as housekeeper. He enlarged the house following his marriage to Miss Finella Fueller in March, 1895. The newlyweds set up housekeeping in the house in April, in advance of which it was reported a "handsome lot of furniture" was delivered to the home. The Whinnerys continued to live at 605 Silver Street until 1897 when they moved to 531 Gunnison Avenue.

605 Silver Street is prominently located on a group of corner lots comprising Lots 11 to 16, Block 25; the property and improvements were alternately taxed to W.S. Whinnery, Finella Whinnery or W.S. Whinnery & Co. from 1893 to 1919. From 1897 the house was rented, its first post-Whinnery occupant being businessman George J. Richards, followed by another Lake City businessman, Lucius Taliaferro, who moved in in June, 1899. By 1925 ownership of the house passed to James Carris (1884-1941), an African-American resident who lived in the home with his wife, Bonnie, and daughter, Jean Marie. Mr. Carris was employed by the Hinsdale County Road & Bridge Dept.

Other later owners of the property included noted Federal Farm Security Administration photographer Russell Lee, who acquired the house and lots in 1946, later selling to George Fesser of the Lake City light plant; Lawton, Oklahoma, businessman Sidney L. Waller owned the house 1958-1971, completing the single-story front room addition prior to selling the property to Larry and Sylvia Pavich in 1971. The Paviches built the garage addition in 1972. Current owner is Stephen Johns who acquired the property with his mother, Aldene Caley Herman

36. Sources of information:

Hinsdale County Tax Rolls, 1893-1940; Lake City TIMES, March 17, 1892, December 29, 1892, October 19, 1893, page 3, November 9, 1893, page 3, November 23, 1893, page 3, January 11, 1894, page 3, May 3, 1894, page 3, April 11, 1895, page 3, September 30, 1897, page 3, June 22, 1899, page 3, May 29, 1913, page 2; Hinsdale PHONOGRAPH, Friday, October 12, 1888, page 4, December 7, 1888, page 2, and December 21, 1888, page 1; Lake City SILVER WORLD, Thurs., September 26, 1918, page 3, and May 26, 2000, page 3; Gunnison NEWS-CHAMPION, Thurs., August 7, 1930, page 1, May 1, 1941, page 8, May 30, 1946, page 6, Thurs., December 4, 1958, page 6, July 1, 1965, pages 1 and 4, June 29, 1967, page 1, Thurs., October 21, 1971, page 2.

## VI. Significance

37. Local landmark: Yes  No  Date of design.: \_\_\_\_\_ Design. authority: \_\_\_\_\_

Within Lake City Historic District (local historic district)

38. Applicable National Register Criteria:

- A. Associated with events that have made a significant contribution to the broad pattern of our history;
- B. Associated with the lives of persons significant in our past;
- C. Embodies the distinctive characteristics of a type, period, or method of construction, or represents the work of a master, or that possesses high artistic values, or represents a significant and distinguishable entity whose components may lack individual distinction; or
- D. Has yielded, or may be likely to yield, information important in history or prehistory
- Qualifies under Criteria Considerations A through G
- Does not meet any of the above National Register criteria

39. Area(s) of significance: Social history, architecture

40. Period of significance: 1893 - 1904

41. Level of significance: National  State  Local

42. Statement of significance:

This house is associated with settlement and development of Lake City during the late 1800s mining era. It is an altered representative of the vernacular dwellings constructed in Lake City during this period.

43. Assessment of historic physical integrity to significance:

Recent alterations have diminished the architectural integrity of this building.

## VII. National Register Eligibility Assessment

44. National Register eligibility field assessment:  Eligible  Not Eligible  Need Data

45. Is there National Register district potential?  Yes  No

Discuss \_\_\_\_\_

If there is National Register district potential, is this building  Contributing  Noncontributing

46. If the building is in an existing National Register district is it?  Contributing  Noncontributing  
(Lake City National Historic District)

## VIII. Recording Information

47. Photograph numbers: Roll 4, frames 27A, 31A-33A; Roll 29, frames 25, 26 Negatives filed at: Lake City Town Hall

48. Report title: 2003 Architectural Survey of Lake City, Colorado

49. Date(s): September 2002 - June 2003

50. Recordors Cathleen M. Norman and Grant E. Houston

51. Organization: Town of Lake City

52. Address: 230 Bluff Street, Lake City CO 81235 53. Phone no. (970) 944-2333

Colorado Historical Society - Office of Archaeology and Historic Preservation  
1300 Broadway, Denver CO 80203 (303) 866-3395

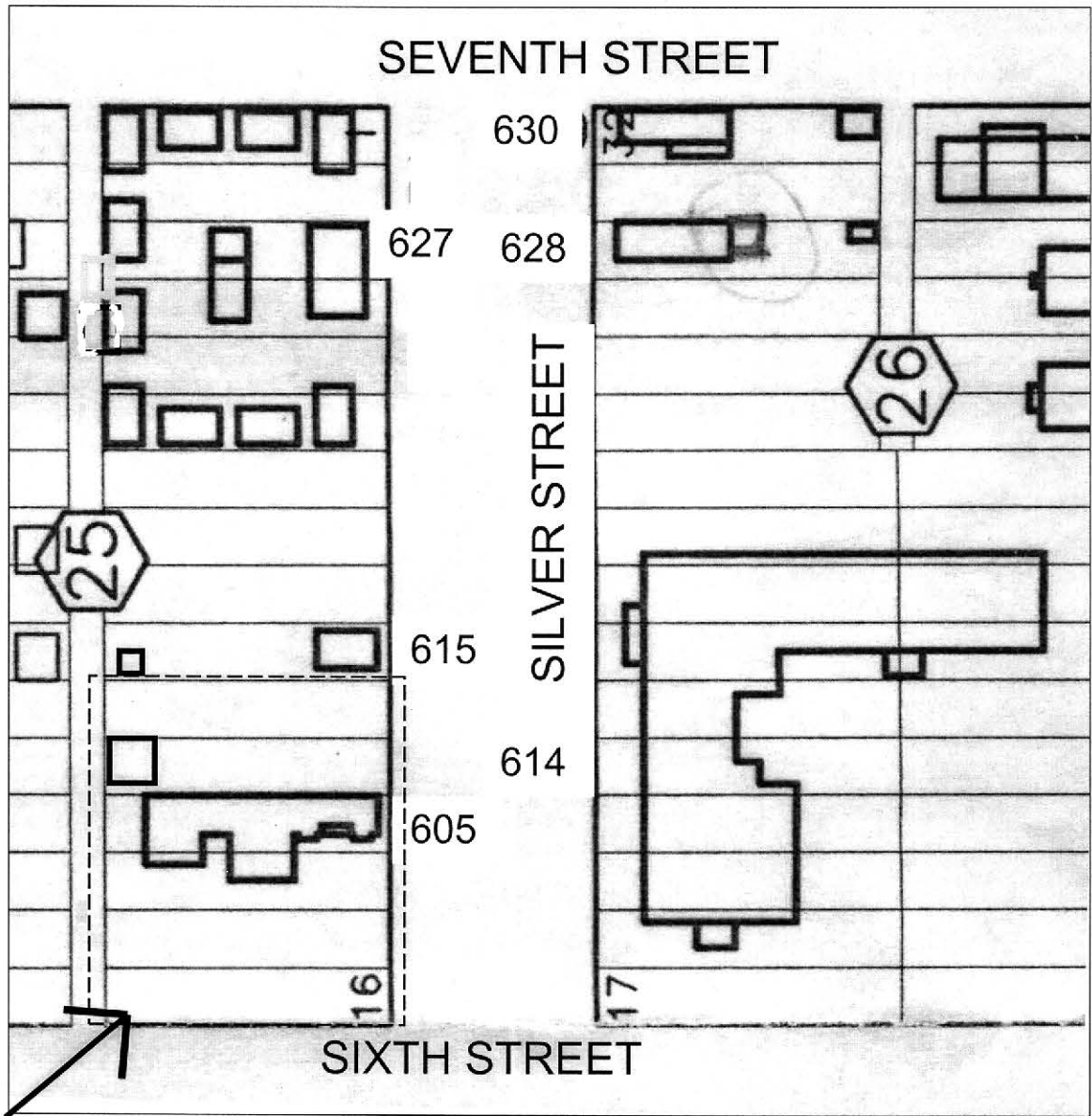

NOT TO SCALE

5HN68.15<sup>127</sup>

605 Silver Street



54N.68.127  
1/2003





54N.68.127  
9/2002



5HN.68.127  
Shed 9/2002

