

SHF  
B  
A  
B  
S/A

# Architectural Inventory Form

## Official Eligibility Determination (for OAHF use only)

- Date \_\_\_\_\_ Initials \_\_\_\_\_
- Determined Eligible - National Register
- Determined Not Eligible - National Register
- Determined Eligible - State Register
- Determined Not Eligible - State Register
- Need Data
- Contributes to eligible National Register District
- Noncontributing to eligible NR District

### I. Identification

- Resource number: 5HN68.56
- Temporary resource number: 5
- County: Hinsdale
- City: Lake City
- Historic building name: ~~Moon-Ramsey House~~ *Dr. George Moon Office + Residence w/ Samuel Rupp Residence w/ Edna Knowlton Ramsey Residence*
- Current building name: *Woods Property*
- Building address: 130 Bluff Street, Lake City, CO 81235
- Owner name and address: Henry Woods, P.O. Box 655, Lake City CO 81235

### II. Geographic Information

County Property No.: R2395

- P.M. *6th NM* Township 44N Range 4W SE4 of SW4 of SW4 of Section 27
- UTM reference  
Zone 13 *9* 296550 mE *3* 4211230 mN
- USGS quad name: Lake City Quad year: 1985 Map scale: X 7.5' 15'
- Block(s): 72 Lot(s): 29-32 Legal: W1/2 of lots 29-32
- Addition: Year of Addition: 0
- Boundary description and justification: Perimeter of parcel

### III. Architectural Description

- Building plan: Rectangular
- Dimensions: 1154 square feet
- Number of stories: 1
- External wall material(s) Wood horizontal siding
- Roof configuration: Hipped
- Roof material: Composition
- Special features:
- General architectural description:  
One-story, hipped-roof frame dwelling. Composition roofing. Walls clad in shiplap siding and trimmed in cornerboards. Façade has off-center entrance with paneled, 9-lite door accessed by wooden stoop; large, fixed-sash window on either side of entrance. Hipped-roof addition on rear has 2-over-2 double-hung windows. East elevation has entrance with paneled, 9-lite door; small deck on southeast corner. South elevation has entrance with glazed and paneled door. Foundation covered in vertical board.
- Architectural style/Building type Hipped-roof Box
- Landscaping or special setting:

24. Associated building, features or objects:

#### IV. Architectural History

25. Date of construction Estimate: \_\_\_\_\_ Actual: 1876 Source of info: SILVER WORLD, January 5, 1878
26. Architect: None Source of info:
27. Builder/contractor: Unknown Source of info:
28. Original owner: Dr. George E. Moon Source of info: SILVER WORLD, January 5, 1878
29. Construction history (major additions, alterations, demolitions):  
Addition built on rear of dwelling in 1994. Source: Tax Assessor records.
30. Original location:  Moved  Date of move(s) 1993

#### V. Historical Associations

31. Original use(s): Single dwelling
32. Intermediate use(s):
33. Current use(s): Single dwelling
34. Site type(s):
35. Historical background:

Dr. George E. Moon, a physician from Saguache, Colorado, built this 28' x 28' frame residence with hip roof in December, 1876, for \$1,500. It was originally located across the street, on lots 17 and 18 near the alley, Block 57 at the alley, fronting Second Street. It was moved in December, 1993 to its present location, 130 Bluff Street, in Block 72. A shed roof addition on the rear of the house was removed prior to the move and a similar addition completed in 1994 on the back portion after its move to the new site.

Dr. Moon used the house as his combined office and residence in the late 1870s. He sold the house to another Lake City physician, Dr. Samuel Rapp, who continued use of the property as his residence in the early 1880s. Rapp's home was at the center of a small Jewish neighborhood at this time. His neighbors included H. & A. Schiffer general merchandise across Second Street, and Dr. Rapp's brother, Abraham, in a neighboring house.

After Dr. Rapp's departure in 1884, the residence became a small boarding house conducted successively by Josephine Cross and Ellen Flora, the latter advertising "clean, comfortable, quiet" rooms in 1888. The house was used as a rental prior to purchase by local school teacher Edna Watson Freeman. Mrs. Freeman later married Vernie Ramsey and remained in the house during her tenure as Lake City elementary teacher from 1915 until retirement in 1952. A wing of Lake City Community School, Edna Knowlton Ramsey Elementary School, is named in her honor.

36. Sources of information:

SILVER WORLD, January 5, 1878; August 14, 1886; March 17, 1888; May 13, 1983 and December 10, 1993; Lake City MINING REGISTER, September 7, 1883.

## VI. Significance

37. Local landmark: Yes  No  Date of design.: \_\_\_\_\_ Design. authority: \_\_\_\_\_  
Within Lake City Historic District (local historic district)
38. Applicable National Register Criteria:
- A. Associated with events that have made a significant contribution to the broad pattern of our history;
- B. Associated with the lives of persons significant in our past;
- C. Embodies the distinctive characteristics of a type, period, or method of construction, or represents the work of a master, or that possesses high artistic values, or represents a significant and distinguishable entity whose components may lack individual distinction; or
- D. Has yielded, or may be likely to yield, information important in history or prehistory
- Qualifies under Criteria Considerations A through G
- Does not meet any of the above National Register criteria
39. Area(s) of significance: Social history, architecture
40. Period of significance: 1876 -1904
41. Level of significance: National  State  Local
42. Statement of significance:  
This dwelling reflects settlement and development of Lake City during the late 1800s mining era. It is one of the few examples of the hipped-roof box dwelling type in Lake City.
43. Assessment of historic physical integrity to significance:  
This building retains its character-defining features, including hipped roof form, horizontal wood materials and transomed doors. However, it is noncontributing to the Lake City Historic District because it was moved to this location from a site one block to the east.

## VII. National Register Eligibility Assessment

44. National Register eligibility field assessment:  Eligible  Not Eligible  Need Data
45. Is there National Register district potential?  Yes  No  
Discuss \_\_\_\_\_
- If there is National Register district potential, is this building  Contributing  Noncontributing
46. If the building is in an existing National Register district is it?  Contributing  Noncontributing  
(Lake City National Historic District)

## VIII. Recording Information

47. Photograph numbers: Roll I, frame 21 Negatives filed at: Lake City Town Hall
48. Report title: 2003 Architectural Survey of Lake City, Colorado
49. Date(s): September 2002 - June 2003
50. Recorders Cathleen M. Norman and Grant E. Houston
51. Organization: Town of Lake City
52. Address: 230 Bluff Street, Lake City CO 81235 53. Phone no. (970) 944-2333

Colorado Historical Society - Office of Archaeology and Historic Preservation  
1300 Broadway, Denver CO 80203 (303) 866-3395

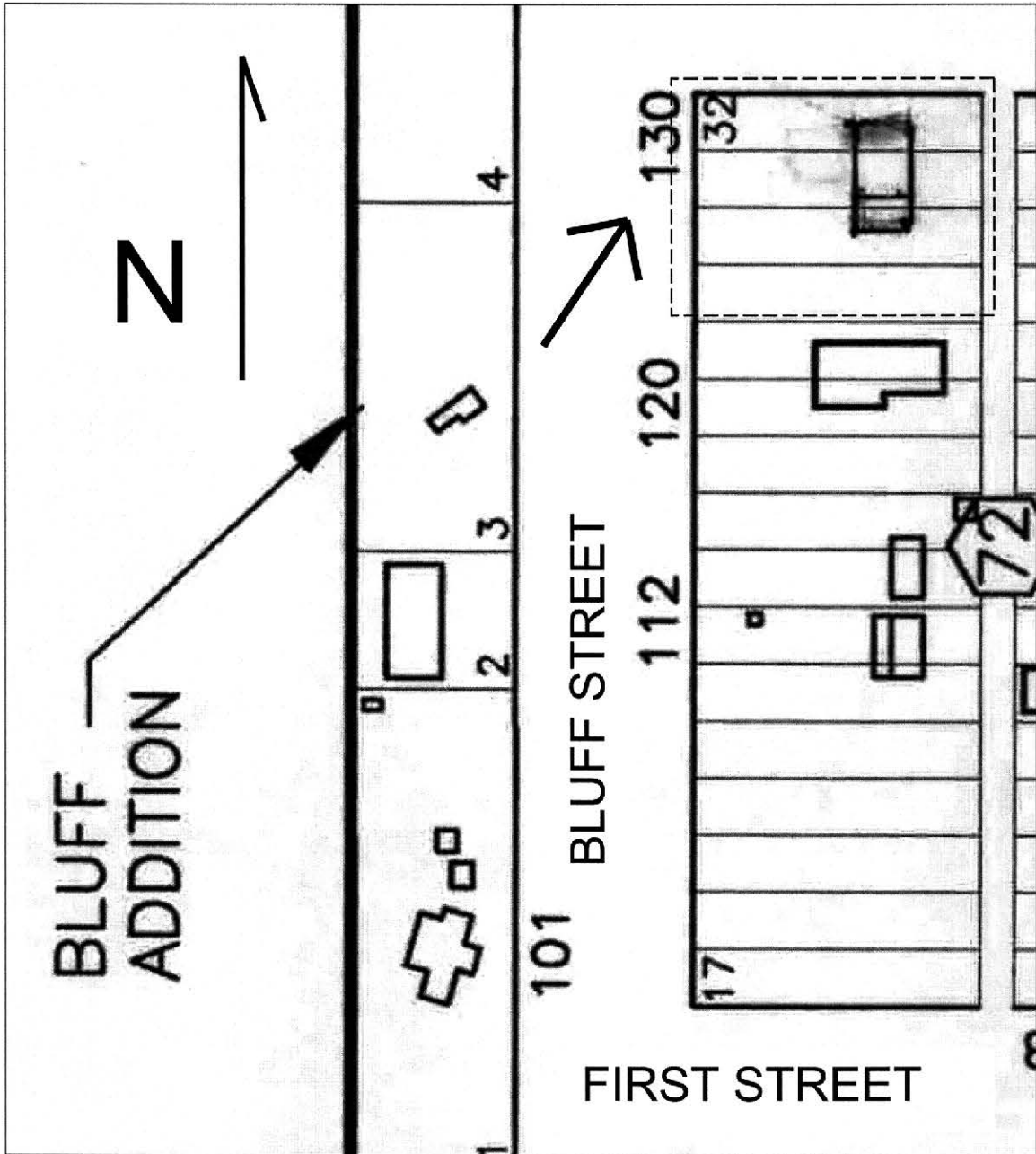

NOT TO SCALE

